

# Butterfly valves

## Butterfly valve type 567 PVC-C Bare shaft



### Model:

- Overall length according to EN 558, ISO 5752
- Connecting dimension: ISO 7005 PN 10, EN 1092 PN 10, DIN 2501 PN 10, ANSI/ASME B 16.5 Class 150, BS 1560: 1989, BS 4504, JIS B 2220
- Interface F07 according to DIN/ISO 5211

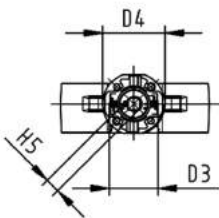
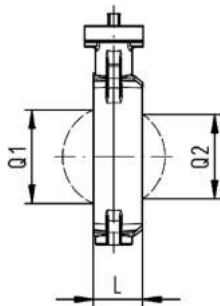
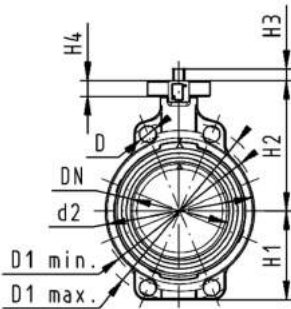

d [mm]	Size [inch]	DN [mm]	PN [bar]	kv-val- ue ( $\Delta p=1$ bar) [l/min]	EPDM Code	SP	Weight [kg]	FPM Code	SP	Weight [kg]
63	2	50	10	1470	<b>163 567 802</b>	1	0.831	<b>163 567 822</b>	1	0.835
75	2 ½	65	10	2200	<b>163 567 803</b>	1	0.947	<b>163 567 823</b>	1	0.952
90	3	80	10	3000	<b>163 567 804</b>	1	1.079	<b>163 567 824</b>	1	1.097
110	4	100	10	6500	<b>163 567 805</b>	1	1.759	<b>163 567 825</b>	1	1.737
140	5	125	10	11500	<b>163 567 806</b>	1	2.361	<b>163 567 826</b>	1	2.379
160	6	150	10	16600	<b>163 567 807</b>	1	3.289	<b>163 567 827</b>	1	3.364
225	8	200	10	39600	<b>163 567 808</b>	1	5.269	<b>163 567 828</b>	1	5.094

d [mm]	PTFE Code
63	<b>163 567 832</b>
75	<b>163 567 833</b>
90	<b>163 567 834</b>
110	<b>163 567 835</b>
140	<b>163 567 836</b>
160	<b>163 567 837</b>
225	<b>163 567 838</b>

d [mm]	d2 [mm]	D [mm]	D1 min. [mm]	D1 max. [mm]	D3 [mm]	D4 [mm]	H [mm]	H1 [mm]	H2 [mm]	H3 [mm]	H4 [mm]	H5 [mm]	L [mm]	Q1 [mm]
63	104	19	120	125	70	90	222	77	134	27	23	11	45	40
75	115	19	140	145	70	90	235	83	140	27	23	11	46	54
90	131	19	150	160	70	90	247	89	146	27	23	11	49	67
110	161	19	175	191	70	90	287	104	167	16	23	14	56	88
140	187	23	210	216	70	90	313	117	181	16	23	14	64	113
160	215	24	241	241	70	90	335	130	189	19	23	17	72	139
225	267	23	290	295	70	90	387	158	210	19	23	17	73	178

d [mm]	Q2 [mm]
63	
75	35
90	50
110	74
140	97
160	123
225	169

PF 2 32 693 998



# Butterfly valve type 567 PVC-C Hand lever with ratchet settings

## Model:

- Overall length according to EN 558, ISO 5752
- Connecting dimension: ISO 7005 PN 10, EN 1092 PN 10, DIN 2501 PN 10, ANSI/ASME B 16.5 Class 150, BS 1560: 1989, BS 4504, JIS B 2220

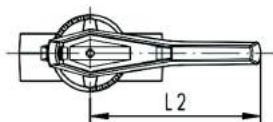
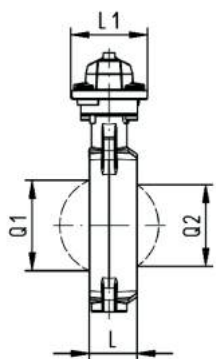
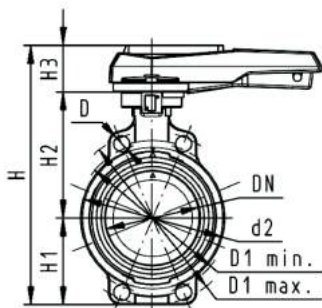

d [mm]	Size [inch]	DN [mm]	PN [bar]	kv-val- ue ( $\Delta p=1$ bar) [l/min]	EPDM Code	SP	Weight [kg]	FPM Code	SP	Weight [kg]
63	2	50	10	1470	<b>163 567 002</b>	1	1.257	<b>163 567 022</b>	1	1.268
75	2 ½	65	10	2200	<b>163 567 003</b>	1	1.366	<b>163 567 023</b>	1	1.174
90	3	80	10	3000	<b>163 567 004</b>	1	1.542	<b>163 567 024</b>	1	1.997
110	4	100	10	6500	<b>163 567 005</b>	1	2.231	<b>163 567 025</b>	1	2.715
140	5	125	10	11500	<b>163 567 006</b>	1	2.820	<b>163 567 026</b>	1	2.536
160	6	150	10	16600	<b>163 567 007</b>	1	6.719	<b>163 567 027</b>	1	3.361
225	8	200	10	39600	<b>163 567 008</b>	1	5.873	<b>163 567 028</b>	1	6.803

d [mm]	PTFE Code
63	<b>163 567 202</b>
75	<b>163 567 203</b>
90	<b>163 567 204</b>
110	<b>163 567 205</b>
140	<b>163 567 206</b>
160	<b>163 567 207</b>
225	<b>163 567 208</b>

d [mm]	d2 [mm]	D [mm]	D1 min. [mm]	D1 max. [mm]	H [mm]	H1 [mm]	H2 [mm]	H3 [mm]	L [mm]	L1 [mm]	L2 [mm]	Q1 [mm]	Q2 [mm]
63	104	19	120	125	264	77	134	54	45	106	205	40	
75	115	19	140	145	277	83	140	54	46	106	205	54	35
90	131	19	150	160	289	89	146	54	49	106	205	67	50
110	161	19	175	191	325	104	167	55	56	106	255	88	74
140	187	23	210	216	352	117	181	55	64	106	255	113	97
160	215	24	241	241	373	130	189	55	72	106	255	139	123
225	267	23	290	295	435	158	210	67	73	140	408	178	169

PF 2 32 693 001

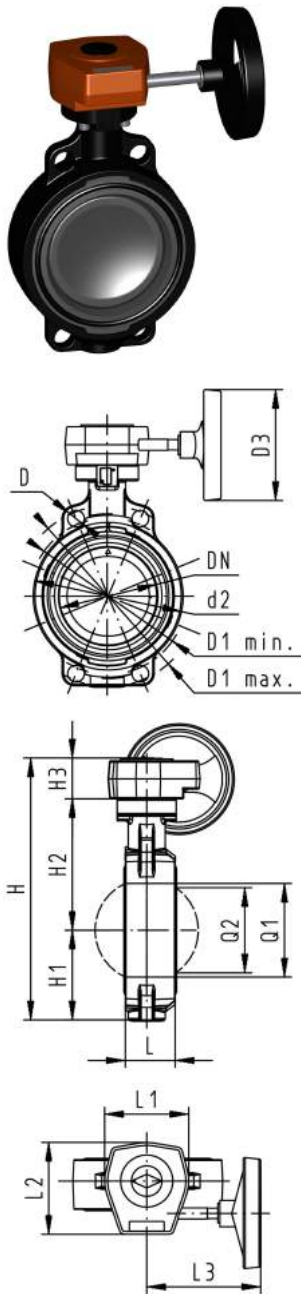

## Butterfly valve type 567 PVC-C Reduction gear with handwheel

### Model:

- Overall length according to EN 558, ISO 5752
- Connecting dimension: ISO 7005 PN 10, EN 1092 PN 10, DIN 2501 PN 10, ANSI/ASME B 16.5 Class 150, BS 1560: 1989, BS 4504, JIS B 2220

d [mm]	Size [inch]	DN [mm]	PN [bar]	kv-value (Δp=1 bar) [l/min]	EPDM Code	SP	Weight [kg]	FPM Code	SP	Weight [kg]
63	2	50	10	1470	<b>163 567 042</b>	1	3.078	<b>163 567 062</b>	1	3.078
75	2 ½	65	10	2200	<b>163 567 043</b>	1	3.201	<b>163 567 063</b>	1	3.212
90	3	80	10	3000	<b>163 567 044</b>	1	3.384	<b>163 567 064</b>	1	3.391
110	4	100	10	6500	<b>163 567 045</b>	1	4.019	<b>163 567 065</b>	1	4.033
140	5	125	10	11500	<b>163 567 046</b>	1	4.526	<b>163 567 066</b>	1	4.526
160	6	150	10	16600	<b>163 567 047</b>	1	5.601	<b>163 567 067</b>	1	5.624
225	8	200	10	39600	<b>163 567 048</b>	1	7.326	<b>163 567 068</b>	1	7.354

d [mm]	PTFE Code
63	<b>163 567 242</b>
75	<b>163 567 243</b>
90	<b>163 567 244</b>
110	<b>163 567 245</b>
140	<b>163 567 246</b>
160	<b>163 567 247</b>
225	<b>163 567 248</b>

d [mm]	d2 [mm]	D [mm]	D1 min. [mm]	D1 max. [mm]	D3 [mm]	H [mm]	H1 [mm]	H2 [mm]	H3 [mm]	L [mm]	L1 [mm]	L2 [mm]	L3 [mm]	Q1 [mm]
63	104	19	120	125	150	278	77	134	50	45	110	120	155	40
75	115	19	140	145	150	291	83	140	50	46	110	120	155	54
90	131	19	150	160	150	303	89	146	50	49	110	120	155	67
110	160	19	175	191	150	339	104	167	50	56	110	120	155	88
140	187	23	210	216	150	365	117	181	50	64	110	120	155	113
160	215	24	241	241	150	387	130	189	50	72	110	120	155	139
225	267	23	290	295	150	436	158	210	50	73	110	120	155	178

d [mm]	Q2 [mm]
63	
75	35
90	50
110	74
140	97
160	123
225	169

PF 2 32 693 001