



## Diaphragm valve type 517 PVC-C With backing flanges PP-V metric/BS

### Model:

- Double flow rate compared to predecessor
- One housing nut replaces four screws
- Handwheel with built-in locking mechanism
- Flat sealing faces
- Overall length EN 558
- Connecting dimension: ISO 7005 PN 10, EN 1092 PN 10, DIN 2501 PN 10, BS 4504 PN 10

### Option:

- Individual configuration of the valve (see diagram)
- Self adjusting multifunctional module with integrated limit switches

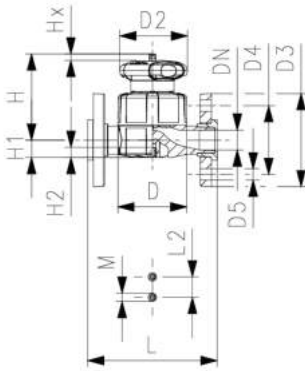

d [mm]	DN [mm]	PN [bar]	kv-value ( $\Delta p=1$ bar) [l/min]	EPDM Code	SP	Weight [kg]	PTFE/EPDM Code	SP	Weight [kg]
20	15	10	125	<b>163 517 112</b>	1	0.447	<b>163 517 132</b>	1	0.528
25	20	10	271	<b>163 517 113</b>	1	0.695	<b>163 517 133</b>	1	0.695
32	25	10	481	<b>163 517 114</b>	1	1.388	<b>163 517 134</b>	1	0.952
40	32	10	759	<b>163 517 115</b>	1	1.797	<b>163 517 135</b>	1	1.818
50	40	10	1263	<b>163 517 116</b>	1	2.854	<b>163 517 136</b>	1	2.142
63	50	10	1728	<b>163 517 117</b>	1	3.318	<b>163 517 137</b>	1	3.115

d [mm]	D [mm]	D2 [mm]	D3 [mm]	D4 [mm]	D5 [mm]	H [mm]	H1 [mm]	H2 [mm]	L [mm]	L2 [mm]	M	Lift = Hx [mm]	closest inch [inch]
20	65	65	95	65	14	73	14	12	130	25	M6	7	1/2
25	80	65	105	75	14	81	18	12	150	25	M6	10	3/4
32	88	87	115	85	14	107	22	12	160	25	M6	13	1
40	101	87	140	100	18	115	26	15	180	45	M8	15	1 1/4
50	117	135	150	110	18	148	32	15	200	45	M8	19	1 1/2
63	144	135	165	125	18	166	39	15	230	45	M8	25	2

PF 2 31 158 064