

# ENC CARD(SECO-EN2000)

SECO 2000Series

Model No. : SECO EN2000

## I . UNIT DESCRIPTION

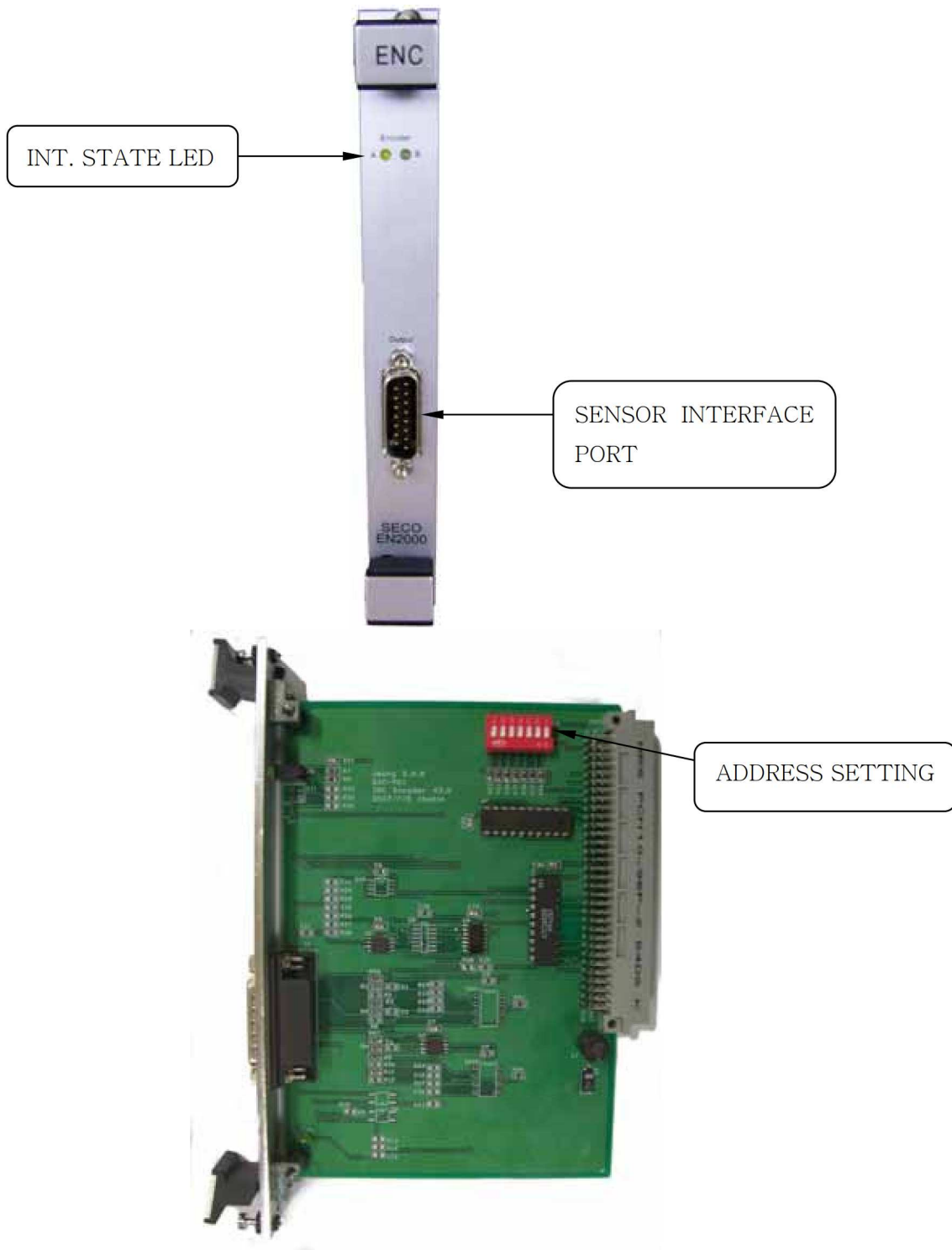

# ENC CARD(SECO-EN2000)

SECO 2000Series

## II. Specifications

Model: SECO EN2000  
Encoder Counter  
Data Range: 32bits  
Maximum Speed: 10Mhz  
A,B Phase Signal LED  
Line Driver Input

## III. State LED

- A Phase A Latch Signal State  
Encoder A상의 Latch값을 나타낸다.
- B Phase B Latch Signal State  
Encoder B상의 Latch값을 나타낸다.

## IV. CONNECTION

Encoder Interface

Connector

- D-SUB, 15pins, Male

Pin No.	Description
1	A+
2	A-
3	B+
4	B-

# ENC CARD(SECO-EN2000)

SECO 2000Series

## V. UNIT DIMENSION

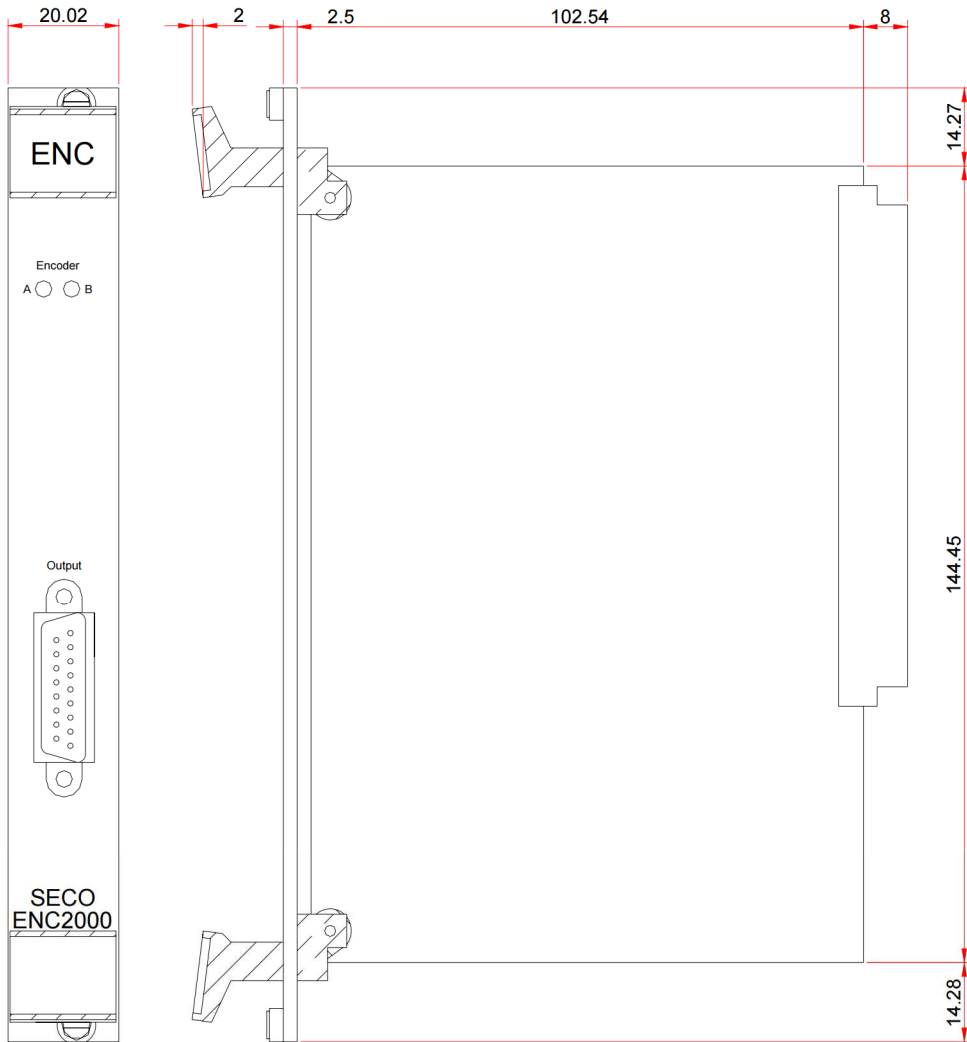

# ENC CARD(SECO-EN2000)

SECO 2000Series

## VI. Notes

SGHITEC	Address: 19, Namsan 4-gil, Gwangyang-si, Jeollanam-do, 57722, Korea
	Tel : (061)791-4475 Fax: (061)792-4024
URL	<a href="http://www.sgtec.org">http://www.sgtec.org</a>
E-mail	<a href="mailto:sgtec@sgtec.org">sgtec@sgtec.org</a>